



FORMBY HALL

GOLF RESORT & SPA

CONFERENCES, MEETINGS & EVENTS



WELCOME TO BUSINESS CLASS

They say you shouldn't mix business with pleasure but, at Formby Hall Golf Resort & Spa, it is difficult not to. Set in over 200 acres of lush green landscape, our 4-star luxury hotel, golf resort and spa has five meeting/conference rooms, each varying in size to suit any type of meeting or conference, and all presented in the same high quality and equipped with state-of-the-art facilities.

Our dedicated Conference Team are on hand to help you plan and co-ordinate your event from start to finish – from advising you on the most suitable rooms and configuration, to the food and beverage you require. All to ensure that your event runs as smoothly as it possibly can.

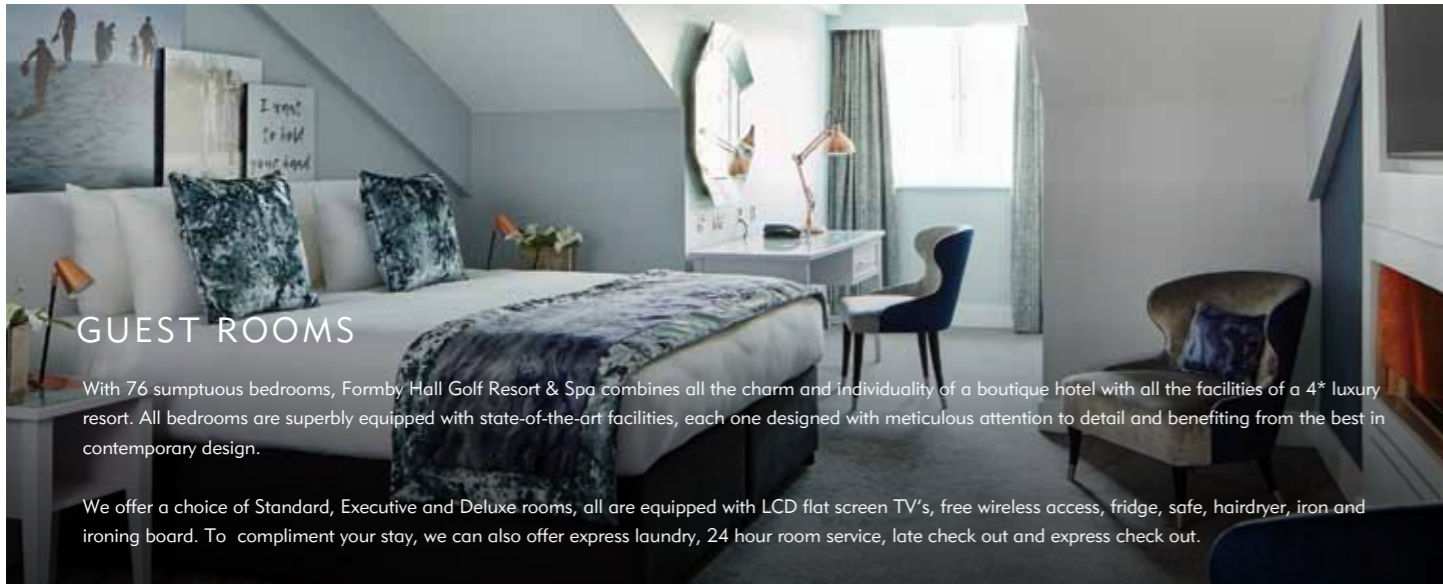

GUEST ROOMS

With 76 sumptuous bedrooms, Formby Hall Golf Resort & Spa combines all the charm and individuality of a boutique hotel with all the facilities of a 4* luxury resort. All bedrooms are superbly equipped with state-of-the-art facilities, each one designed with meticulous attention to detail and benefiting from the best in contemporary design.

We offer a choice of Standard, Executive and Deluxe rooms, all are equipped with LCD flat screen TV's, free wireless access, fridge, safe, hairdryer, iron and ironing board. To compliment your stay, we can also offer express laundry, 24 hour room service, late check out and express check out.

CONFERENCE PACKAGES

Ideally located between Liverpool and Southport, Formby Hall Golf Resort & Spa makes business a pleasure. Upon arrival, you are allocated a dedicated conference manager with technical support for your AV requirements to ensure the smooth running of your event. Added to this, we can also offer support for any secretarial services you may require.

24HR CONFERENCE PACKAGES

This package is suitable for all meetings with 10 or more delegates. The package includes:

- Main room hire
- Free Wireless Internet Access
- Pens, Pads and Stationery
- Unlimited servings of fresh tea and coffee throughout the day with homemade cakes or pastries
- Tailor made lunch options including hot or cold buffets or sit-down delegate luncheons
- Mineral water, sweets and fresh fruit in your meeting room
- Three-course dinner
- Accommodation in standard room with Full English breakfast
- Car parking for up to 460 cars

DAY DELEGATE PACKAGES

This package is suitable for all meetings with 10 or more delegates. The package includes:

- Main room hire
- Free Wireless Internet Access
- Pens, Pads and Stationery
- Unlimited servings of fresh tea and coffee throughout the day with homemade cakes or pastries
- Tailor made lunch options including hot or cold buffets or sit-down delegate luncheons
- Mineral water, sweets and fresh fruit in your meeting room
- Car parking for up to 460 cars

All meeting/conference rooms enjoy natural daylight and there are fantastic views of the course from the Ambassador and Diplomat suites.



View our 3D tour by visiting
<https://my.matterport.com/show/?m=mfhqVDD7zoM>

AMBASSADOR SUITE

Room Features

- Room can be divided into 3 separate areas
- Large LCD screens for laptop presentation
- Free wireless broadband internet access
- Fully air conditioned
- Single serve coffee machines available
- Terrace
- Natural daylight
- Views over the golf course

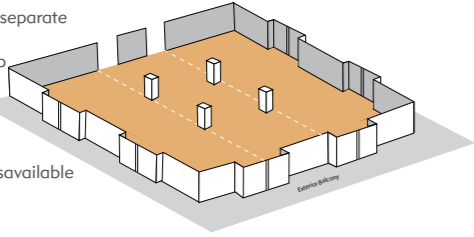

Room Dimensions

Area (m)	Length (m)	Width (m)
325	25	13

Room Set-up Options

Theatre	Class Room	U Shape	Dinner	Board Room
300	100	60	300	60

DIPLOMAT SUITE

Room Features

- Large LCD screens for laptop presentation
- Free wireless broadband internet access
- Fully air conditioned
- Single serve coffee machines available
- Terrace
- Natural daylight
- Views over the golf course
- Separate bar area with lounge seating

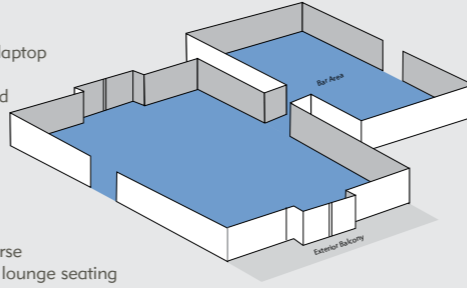

Room Dimensions

Area (m)	Length (m)	Width (m)
252	21	12

Room Set-up Options

Theatre	Class Room	U Shape	Dinner	Board Room
150	40	50	160	60

LINKS SUITE

Room Features

- Large LCD screen for laptop presentation
- Free wireless broadband internet access
- Fully air conditioned
- Single serve coffee machines available
- Natural daylight

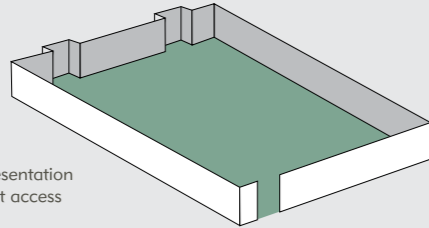

Room Dimensions

Area (m)	Length (m)	Width (m)
63.51	8.7	7.3

Room Set-up Options

Theatre	Class Room	U Shape	Dinner	Board Room
48	30	20	40	22

PARKLAND SUITE

Room Features

- Large LCD screen for laptop presentation
- Free wireless broadband internet access
- Fully air conditioned
- Single serve coffee machines available
- Natural daylight
- Views over golf course

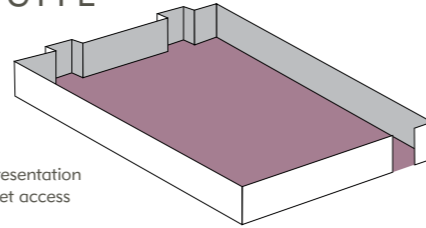

Room Dimensions

Area (m)	Length (m)	Width (m)
63.36	7.2	8.8

Room Set-up Options

Theatre	Class Room	U Shape	Dinner	Board Room
40	30	20	40	22

SPA AND HEALTH CLUB

Formby Hall's luxury spa offers a haven from the rigours of daily life, a sumptuous oasis of peace and tranquility. This is one of the leading luxury spa hotels in the North West and offers an extensive range of treatments and holistic therapies for both men and women. Contact our dedicated sales team for information on incorporating your conference or event with a visit to our luxury spa.

Our Health Club offers a fully equipped gymnasium, including 80 classes a week, Les Mills Virtual and top of the range gym equipment, along with a 20m Heated Indoor Swimming Pool, hydrotherapy pool, poolside thermal suites including, Himalayan Salt Sauna, Essence Infused Laconium Cabin, Spa Bath, Steam Room, Ice Fountain and Experience Showers.



CORPORATE GOLF

Set in the heart of England's Golf Coast and with the choice of an 18 hole Championship Course, a 9 hole Woodhey Dunes Course, the Tommy Fleetwood Academy, PGA Academy, and Swash Putting Solutions, Formby Hall Golf Resort & Spa represents the finest in corporate golf entertaining across the North West.

Whether a seasoned professional or beginner, we have something to offer everyone - be it one of our three standard Corporate Golf Packages or a tailor-made package to suit your exact requirements. Our Golf Sales Team are here to offer their expert advice every step of the way.



EXECUTIVE RETREATS

Ideal for executive board away days or off-site team meetings, either with accommodation or just for the day!

Packages Include:

- Meeting room for board discussions and a separate lounge for breaks
- Bacon Rolls or overnight oats on arrival
- Fruit platter in main meeting room
- Executive 2 course buffet lunch in a private room or Fairway restaurant
- Upgraded coffee breaks including hot chocolate, fruit smoothies, homemade cookies
- Activities including clay pigeon shooting, archery, golf, spa, giant Scalextric, bake off, cocktail making and many more!
- LCD projector and screen

* based on 10 or more delegates



COUNTRY PURSUITS

Team building days are a great way to reward your employees and help foster solid working relationships. Events that are fun and motivational help build essential skills like communication, planning and problem solving. As one of the most important investments you will make as a company, it is essential to ensure it is effective.

Your team will love the team building activities on offer at Formby Hall Golf Resort & Spa, with options for both indoor and outdoor activities. Fly around on a speedy Segway, take aim in archery, or try your shot at laser clays or, for something completely different, why not try the latest craze...duck herding!

Whether you want to add a team building activity to your corporate event or provide a full week of activities for the entire company, we can provide all you need for a successful team building experience.

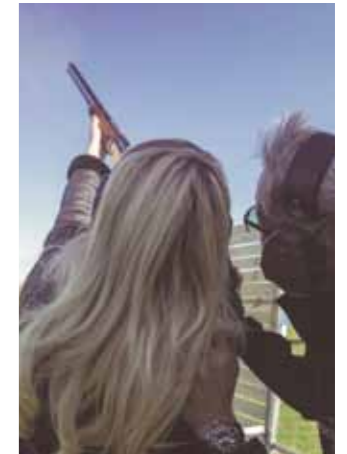

DIRECTIONS TO FORMBY HALL GOLF RESORT & SPA

Close to Southport, Liverpool and Manchester and well served by motorway and rail connections, with London only 2 1/4 hours by train away.
Close to Liverpool John Lennon and Manchester International Airports. Liverpool City Centre is only 30 minutes drive.

Travelling distances and times to the resort:

- Blackpool International Airport (56 miles)
under 90 minutes
- Liverpool (13 miles) Chester (41 miles)
under 30 minutes
- Liverpool John Lennon Airport (25 miles)
under 30 minutes
- London Euston Station (221 miles)
under 2.5 hours
- Manchester City Centre (40 miles)
within one hour
- Manchester International Airport (45 miles)
within one hour
- Southport (6 miles)
under 15 minutes

Nearest Train Station: Freshfield
(on Northern Line 2 miles) Nearest Airport:
Liverpool John Lennon (25 miles)
Helipad available at Formby Hall

